

## Borderguard (continued)

### Follow these steps to change the battery:

1. Use screw driver to turn the blue slot (located on the bottom of sensor) counter clockwise to release the front cover.
2. Depress the 2 tabs located on the top inside of the sensor to release the sensor from its case. The transmitter is located on the backside of the sensor module.
3. Locate and replace the CR123A battery, being careful to align the positive (+) and negative (-) ends as indicated by the markings inside the battery housing.
4. Press the black RESET button on the transmitter opposite the battery (Fig.1).
5. Test the sensor. (For directions on testing the sensor, see reverse page)

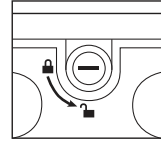

Fig. 1 (transmitter with case open)



3V CR 123A battery

Be sure to press the reset button after changing the battery



## Borderguard



### GENERAL INFORMATION

The Borderguard Dual Beam Motion Detector can be placed up to 2000 ft from the tattletale™ base unit. The Borderguard is designed to protect the exterior of a building, property, or fence. It is sensitive to moving heat and has an adjustable coverage area. The detector utilizes dual beams to project up to 40 ft from each side of the sensor (Fig. 2, see reverse page). It can operate normally between -4°F and 122°F, is weather resistant, and IP55 rated. The 3V CR123A Lithium battery provided will typically last for 2-3 years depending on usage and environment.

### Mounting instructions:

1. Use screw driver to unlock front cover, remove front cover, depress tabs to remove the center section the back housing.

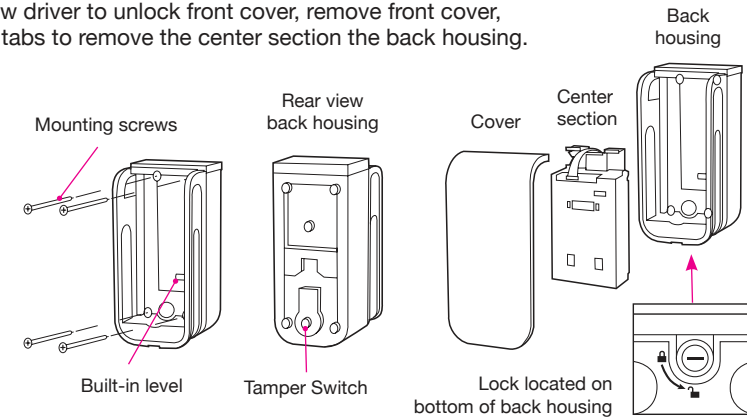

2. Screw back casing of the unit to a permanent post or exterior of the building. Make sure the sensor is mounted securely with tamper switch fully depressed. Use integrated level to assure proper leveling of sensor. Failure to do so could result in undesired operation.
3. Mount the Borderguard at a height of 31" to 48" (ideally 48".) (The sensor is looking for knees and shoulders of an intruder.)
5. Reattach center section to the back housing by inserting the bottom tabs into the housing first and then rotating the part forward until the tabs lock in place.
6. Reattach the front cover by first inserting the top of the cover into the back housing, then rotating the front cover downwards and pushing firmly to lock it in place.



# Borderguard (continued)

## Individual Detection Area & Sensitivity Setting

### Detection distance adjustment

There are two multiple-position switches on the lower section of the sensor that allow you to set the detection distance of each side of the sensor. The detection distance can be set to 8ft, 12ft, 20ft, 28ft, or 40ft. The distances are labeled on the sensor for ease of installation. The factory default setting is the maximum distance, 40ft. (fig. 2)

Sensitivity switches and dip switches located under front cover

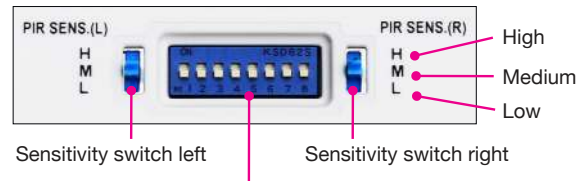

(Dipswitches 1-8 correspond with the definitions below)

### Dipswitches

1. LED setting. When enabled, an LED will light up every time the sensor detects motion. We recommend leaving this in the off position to conserve battery life.
2. This switch MUST be left in the OFF position.
3. This switch must also be left in the OFF position.
4. This switch greatly increases the sensitivity of the sensor's left side. This should be left in the OFF position unless the ambient temperature of the environment is close to 98 degrees Fahrenheit.
5. Same as #4 but for the sensor's right side
6. This switch changes the length of the battery saving timer. We recommend leaving it in the OFF position to conserve battery life. OFF=120 second sleep timer. ON=5 second sleep timer
7. This switch enables anti-masking. We recommend enabling this dipswitch at the time of installation.
8. This switch MUST be left in the OFF position.

### Dual beam technology reduces false alarms



### Automatic Walk test

Walk test mode will time out after three minutes, then the sensor will resume normal operation.

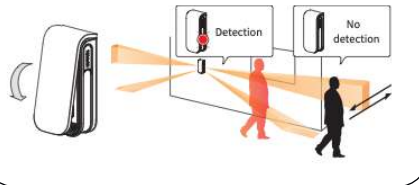

### (fig. 2)

40 ft. range on both sides of sensor (maximum distance)

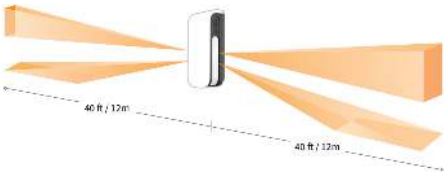

## General Troubleshooting

When there is an issue with your Borderguard (or one of your other sensors), the tattletale base unit will display a message on its screen which says either **“Sensor Open”** or **“Other Issues.”** If you see either of these messages displayed, press 3 on the keypad, then enter your 4-digit PIN to get more information about what is going on with the sensor.

If the screen shows your Borderguard's status to be **“OPEN,”** that means one of two things: 1) The Borderguard is actively seeing motion or 2) The Borderguard is not put together properly.

If the Borderguard's status is **“LOST,”** verify that it is within range of the tattletale base unit and that the sensor has a working battery in the transmitter. If that doesn't return it to normal status a tattletale signal booster might be needed.

If the Borderguard's status is **“LOW BATTERY,”** replace the CR123A battery in its transmitter and press the black RESET button.

### Testing the Borderguard

The Borderguard preserves battery life for 2-3 years by going into a “Sleep Mode,” meaning that once tripped, the sensor will not report motion detection again until there have been 120 seconds of no activity.

**It is not necessary to arm your tattletale base unit to perform this test. To avoid alarm events, leave your base unit disarmed or put the system on test drive.**

1. Make sure that no one has been in the Borderguard's detection area for at least 3 minutes.
2. Unplug the tattletale base unit and carry it to the area where the Borderguard is mounted.
3. When you trip the sensor, you should briefly see a “Sensor Open” message appear on the tattletale base unit's display. The message is only displayed for a few seconds. If you see the message appear, the Borderguard is working properly. If you don't see it, leave the area of the sensor for at least 3 minutes and repeat the test.
4. Reconnect the tattletale base unit's power cord.

