

# Wireless Siren and Strobe system



Thank you for choosing tattletale! Everything we've learned from protecting the toughest sites across America since 1998 has gone into developing this rugged all weather wireless system to extend the auditory and visual alert capability of your tattletale alarm system anywhere you need it.

## How it works

When an alarm event is triggered the tattletale base sends an instant signal via transmitter to a receiver attached to the Siren/Strobe creating a wireless connection instantly activating the Siren/ Strobe at a range of up to 2,000 ft.

## Features:

- Dual tamper protection
- Loud 120db warble tone siren
- High intensity strobe synchronized to siren
- Sturdy aluminum back plate
- Strong weatherproof polycarbonate housing

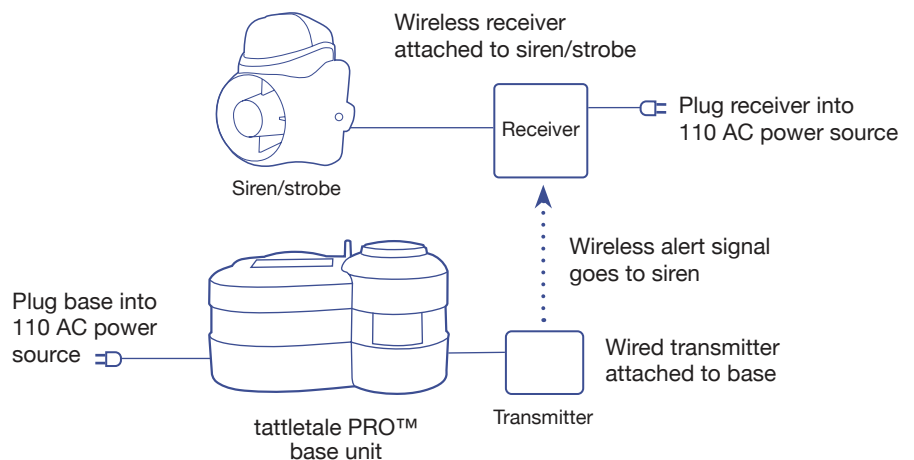

# Wireless Siren and Strobe System (continued)

## Set-up is easy, just follow these simple steps

1. Remove individual components from the box Identify the wired transmitter (fig. a).
2. Install transmitter battery. With the screw driver provided, remove the case cover from the transmitter. The battery is shipped loose in the case and needs to be installed (fig. b) and (fig. c).
3. Plug wired transmitter into your tattletale PRO base unit (fig. d).
4. Identify the AC power supply and the wireless receiver unit. (note this power supply is a different voltage than the power supply use with the tattletale PRO base unit and should be used with the receiver unit only). Plug the power supply into receiver unit (fig. e)
5. When the power supply is plug into 110 AC power the LCD screen visible through the clear case should read: SIREN READY (fig. f)
6. Plug siren cable into receiver unit (fig. g)



Fig. a: Wired transmitter



Fig. b: Remove cover



Fig. c: Install battery



Fig. d: Plug transmitter into the back of the PRO base unit



Fig. e: Plug power supply into the wireless receiver



Fig. f: Ready indication



Fig. g: Plug siren/strobe into receiver

## If you fail to get an immediate "Ready!" indication

In nearly all cases your wireless siren system should arrived pre-programmed from the tattletale factory, this will be indicated by the "Ready!" indication in (fig. f) Note: failing to install the transmitter battery in (step 2) will prevent a "Ready!" indication.

If factory programming is not complete the screen will say "no transmitter", meaning that the system is not recognizing the transmitter you will need to press the black "ENTER" button on the siren base twice then press the black "RESET" button on the transmitter by where they installed the battery. The screen should then say "transmitter added" press "BACK" twice you should see a ready screen.



# Wireless Siren and Strobe System (continued)

## Mounting instructions

- Remove the back cover by loosening the two side screws.  
(See Fig. g)
- Mount the back plate onto a secure fixture. If you have to disconnect the front cover to mount it, remember the position of the two leads (red on top, black on the bottom).
- Replace the front cover and tighten the two side screws.

**Fig. g:** Wireless siren and strobe with cover removed

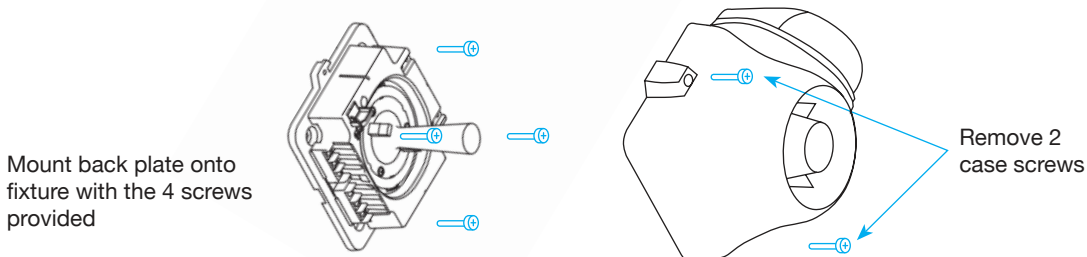

## Testing the remote siren/strobe

- Call 1-888-835-5668 to put your account on test. The tattletale™ does not need to be armed to test the siren/strobe.
- Press the \* and # buttons at the same time to sound an instant alarm. (If your account is not on test when you do this, the police will be dispatched).
- Enter your 4 digit arming code to turn off the siren.
- The remote siren/strobe should activate when the siren and strobe on the tattletale™ activates. If this does not happen, examine the connection between the plug and the jack on the back of the tattletale™.

## Troubleshooting

- If the siren & strobe begins to sound when the tattletale™ is not armed or during a non-alarm, the battery in the transmitter may need to be replaced.
- Open the transmitter connected to the tattletale™ siren & strobe port and replace the battery with a 3.0 Volt Lithium Ion Type 123 cylindrical battery available at any photo store.

Call 1-888-835-5668 for assistance.

